



Cordless Chain Saw
UC031G



XGT
40V **max**
BL MOTOR

Excellent combination of high efficiency and a lightweight design



Accessories (optional)

Guide bar / Saw chain / Guide bar cover / File diameter / Drive sprocket



Cutter type:
MC: Micro chisel



Drive sprocket



Guide bar			Saw chain						Drive sprocket		
Bar length	Type	Part No.	No. of drive links	Gauge	Pitch	Cutter type	Type OREGON	Saw chain Part No.	Bar cover Part No.	Pitch/ No. of teeth	Part No.
25cm/10"	Sprocket nose bar (Micro-Lite)	191T85-8	46	1.1mm/ .043"	.325"	80TXL	MC	191T89-0	413X66-9	.325" / 7	1916N6-4

File and File holder

The file holder guides sharpening at 30° and controls depth to 4/5 of the file diameter.

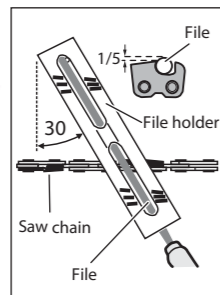

Size	Saw chain type	File and File holder
		Part No.
4.0mm	80TXL	D-70948
4.5mm	90PX	D-70954

Spike bumper set

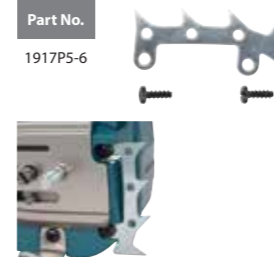

Chain oil

Capacity	Part No.
100ml	199897-3
1L	195093-1



UC031GZ 250 mm (10")

Cordless Chain Saw

40Vmax



*Recommended batteries
2.5Ah, 4.0Ah, 4.0Ah (F)



Standard Equipment:
Saw Chain, Guide Bar Case,
Round File, Chain Oil

- GZ: Without Charger & Battery



Guide Bar Length	250 mm (10")
Chain Pitch	0.325"
Chain Gauge	1.1 mm (0.043")
Chain Speed	0 - 24.0 m/s
Chain Oil Tank Volume	150 mL
Dimensions (L x W x H)	295 x 188 x 203 mm (11-5/8 x 7-3/8 x 8")
Net Weight (with battery)	3.2 - 3.8 kg (7.1 - 8.4 lbs)
Work Amount (approx.)	85 cuts with BL4025 100 x 100 mm square cedar timber with 80 TXL saw chain



UC031G



PRODUCT
DETAILS
Models and specs
may vary by country

Performance equal to
or greater than

27cc-class
chain saws

Makita Power Tools (Malaysia) Sdn. Bhd. Co. Registration No.: 201301001778 (1031615-M)

HQ & Service Centre

Lot 824, Jalan Subang 5, Subang Industrial Area,
47500 Subang Jaya, Selangor.
Tel: 03-8023 0824 (General) | Fax: 03-8022 1448
03-8022 1443 (Service)

Johor (Johor Bahru) Service Centre

No.12 & 14, Jalan Rosmerah 2/9,
Taman Johor Jaya,
81100 Johor Bahru, Johor.
Tel: 07-364 9406 | Fax: 07-364 9407

Sarawak (Kuching) Service Centre

Lot 1227, Lorong Demak Indah 2A,
Demak Laut Industrial Area, Phase 2A,
93250 Kuching Sarawak.
Tel: 082-496 800 | Fax: 082-496 900

Sabah (Kota Kinabalu) Service Centre

Lot 19, Jalan Buah Duku,
Kolombong Light Industrial Estate, Off Jalan Kolombong,
Kolombong Zone 1, 88450 Inanam, Kota Kinabalu, Sabah.
Tel: 088-388 278 | Fax: 088-388 279

FOLLOW MAKITA MALAYSIA:



www.makita.my



Excellent tool balance with optimal center of gravity

A shorter distance between the top handle and the center of gravity improves balance and reduces arm strain during horizontal cutting.

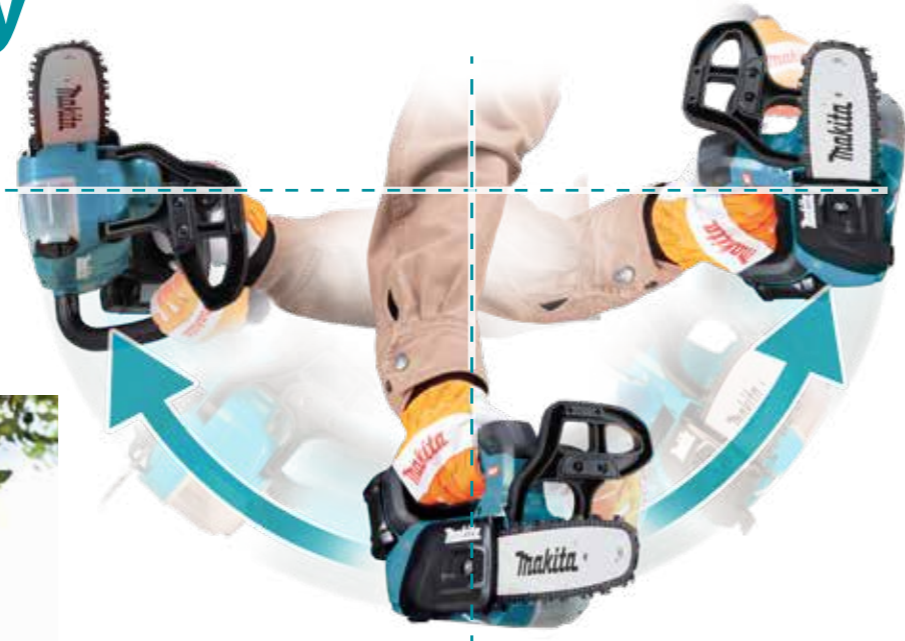

Lightweight
at **3.2 kg**

with BL4025, Guide bar 250mm
Saw Chain 80TXL

Work amount on a full
battery charge

Approx. **85 pcs**

With BL4025, 80TXL saw chain
Cutting 100 x 100 mm square cedar timber

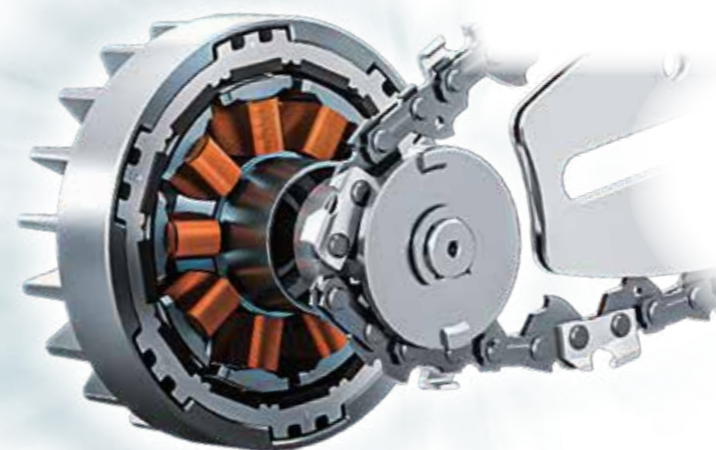

BL
MOTOR

High efficiency with
Outer-rotor brushless motor
and Direct-drive system

Excellent acceleration

Enhanced trigger response provides fast acceleration, enabling efficient continuous and repetitive cutting tasks such as pruning.

Chain speed
24.0 m/s

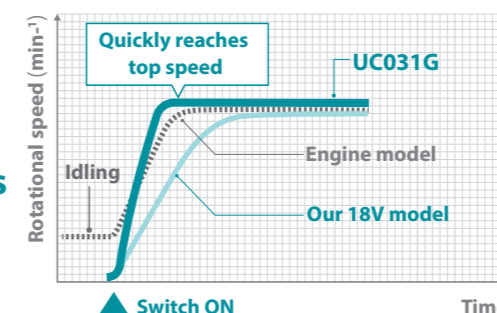

Excellent restartability (when locked)

If the tool locks due to load, removing the load immediately allows the motor to start again without retriggering, making it possible to resume cutting operations.

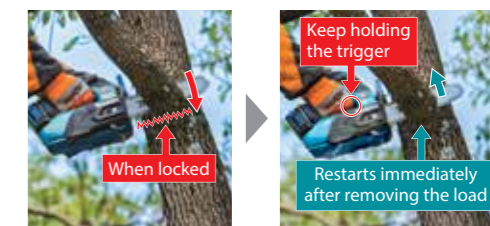

Main power button with enhanced operability

The button provides tactile feedback. The main power lamp and the two-color warning lamp clearly indicate power and error states.

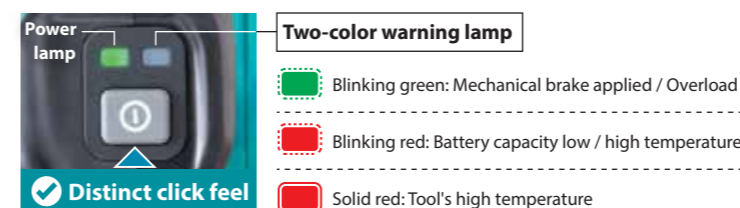

Hook with quick attachment/detachment

Allows one-handed attachment to and removal from a carabiner or similar devices.

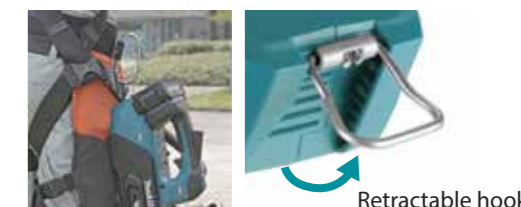

High water-resistance

IPX4
This tool is rated IPX4 for water resistance.

XPT
High water-resistance compatible with eXtreme Protection Technology



■ Captive nuts

prevent loss of nut when removing sprocket cover to replace the guide bar or saw chain.

■ Adjustable automatic chain lubrication

■ Variable speed trigger

Allows for speed adjustments based on the material or application.

■ Chain oil level window

Allows the operator to easily check the oil level.