

Also available

**Cordless Portable Band Saw PB002G**

Max. cutting capacity: 127 mm  
Blade length: 1,140 mm  
Net weight: 6.6 - 7.8 kg



Accessories (optional)

**Band saw blade**

Width : 13 mm  
Thickness : 0.5 mm  
Length : 835 mm

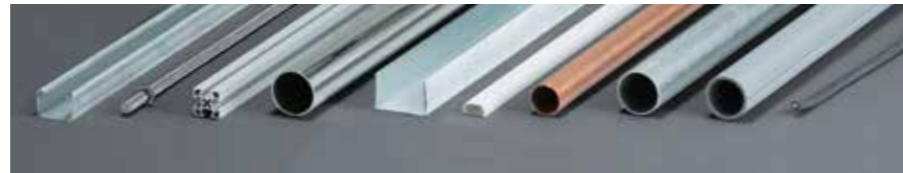

Part No.	Type	Width (mm)	No. of teeth per inch	Teeth shape	Application
B-40543	Bi-Metal (5pc.)	3 mm-6 mm	14	 Wave teeth	Plastics and non-ferrous metal. Mild steel, cast steel and cast iron. Hard steel and stainless steel.
B-40559		2 mm- 3 mm	18		
B-40565		less than 2 mm	24		

**Stand set**

Part No. 1917F0-6



**PB003GZ**

**Cordless Portable Band Saw**

40Vmax



\*Recommended batteries  
2.0Ah, 2.5Ah, 4.0Ah, 4.0Ah (F)



Capacity	Square: 66 x 66 mm (2-5/8 x 2-5/8") Round: 66 mm (2-5/8")
Blade Speed	0 - 3.2 m/s
Blade Size	Length: 835 mm (32-7/8") Width: 13 mm (1/2") Thickness: 0.5 mm (1/64")
Dimensions (L x W x H)	392 x 175 x 244 mm (15-1/2 x 6-7/8 x 9-5/8")
Net Weight	4.0 - 5.2 kg (8.8 - 11.5 lbs.)
Work Amount (approx.)	93 pcs with BL4040F Cutting Ø 48.6 carbon steel pipe, 3.7 mm thickness

Standard Equipment: Band Saw Blade, Hex Wrench, Hook

\* GZ: Without Charger, Battery & Carrying Case



Makita Power Tools (Malaysia) Sdn. Bhd. Co. Registration No.: 201301001778 (1031615-M)

HQ & Service Centre

Lot 824, Jalan Subang 5, Subang Industrial Area,  
47500 Subang Jaya, Selangor.  
Tel: 03-8023 3824 (General) | Fax: 03-8022 1448  
03-8022 1443 (Service)

Johor (Johor Bahru) Service Centre

No.12 & 14, Jalan Rosmerah 2/9,  
Taman Johor Jaya,  
81100 Johor Bahru, Johor.  
Tel: 07-364 9406 | Fax: 07-364 9407

Sarawak (Kuching) Service Centre

Lot 1227, Lorong Demak Indah 2A,  
Demak Laut Industrial Area, Phase 2A,  
93050 Kuching Sarawak.  
Tel: 082-496 800 | Fax: 082-496 900

Sabah (Kota Kinabalu) Service Centre

Lot 19, Jalan Buah Duku,  
Kolombong Light Industrial Estate, Off Jalan Kolombong,  
Kolombong Zone 1, 88450 Inanam, Kota Kinabalu, Sabah.  
Tel: 088-388 278 | Fax: 088-388 279

FOLLOW MAKITA MALAYSIA:



www.makita.my

**Powerful & Fast Cutting  
for a wide range of materials**

Cutting speed  
about **30%UP**

Cut Carbon steel pipe of 48.6 mm diameter with  
thickness of 3.7 mm using blade supplied with  
machine.  
\*Compared with our 18V model



Max. Cutting capacity  
Round pipe

**Ø 66 mm**

Square pipe  
66 x 66 mm



PB003G



PRODUCT  
DETAILS

Models and specs  
may vary by country.

Cutting speed about **30%UP**  
Cut Carbon steel pipe of 48.6 mm diameter with thickness of 3.7 mm using blade supplied with machine.  
\*Compared with our 18V model



**Max. cutting capacity**  
**Round pipe**  
**Ø 66 mm**  
**Square pipe**  
**66 x 66 mm**

**LED job light**  
A diffusion lens spreads light evenly, reducing blade shadows and making it easier to align the blade with the cutting line.



**Minimizes RPM drop under heavy load.**  
**BL MOTOR**  
**High-power Brushless motor** × **Constant speed control**  
**PB003G**

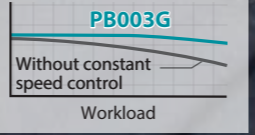

Work amount on a single full battery charge	
Carbon steel pipe ø48.6 x t 3.7 mm	Approx. <b>93 pcs</b> Battery: BL4040F
	Approx. <b>60 pcs</b> Battery: BL4025
Thin steel pipe ø38.1 x t 1.4 mm	Approx. <b>276 pcs</b> Battery: BL4025

**Ensures stable cutting when used with Stand Set**

**Cutting capacity (with stand attached)**  
Round pipe: **ø 55 mm**  
Square pipe: **55 x 55 mm**

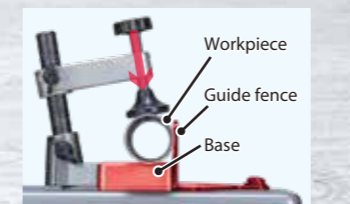
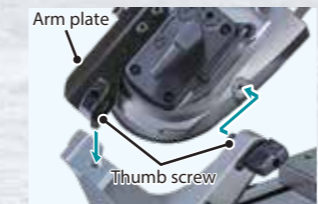

**Easy Installation**  
Mount Arm plate\* on PB003G, and you can secure the band saw to Stand easily with two Thumb screws\* without tool.  
\* Supplied with Stand set

**Stable clamping vise**  
The Vise assembly is designed to slant backward so that it can press the workpiece against both the Guide fence and Base of the stand at a time, providing secure and stable clamping.



**Variable speed control by dial**  
Blade speed adjustable to match the material.

Dial	Blade Speed	Application
1 [Low]	1.3 m/s	Stainless steel, alloy steel, and other hard-to-cut materials
2	1.5 m/s	Steel materials (solid round bar, structural steel, thick steel pipe, etc.)
3	2.1 m/s	
4	2.5 m/s	
5	2.9 m/s	Steel materials (thin steel pipe, etc.)
6 [High]	3.2 m/s	

**Easy positioning of stopper plate without tool**

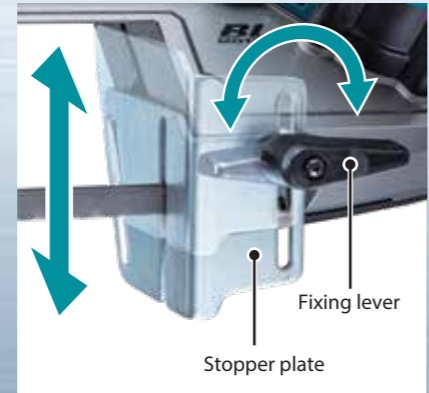

**Easy installation / removal of blade**

Exposed wheel design allows easy blade replacement.



**Externally adjustable blade tracking**

Easily adjustable using the supplied hex wrench.



**Catch bracket**

Designed to hit against workpiece in place of the tool body at the end of cutting process. It can protect the resin housing from scratches and damage.



**Tool hook**

Hangable on ladders, etc.



**Water-resistance compatible with XPT**

